

FOR SALE

**2616-F Lawndale Drive
Greensboro, NC 27408**



1007 Battleground Avenue, Suite 401
Greensboro, NC 27408
336-379-8771



Vince Howard, Broker
vhoward@bipinc.com
P: 336-369-5971
C: 336-202-6314

Kirkwood Commons
2616-F Lawndale Drive
Greensboro, NC 27408

FOR SALE \$199,000

Great small office/studio space off Lawndale Drive, adjacent to the Kirkwood neighborhood. This unit is nestled in the popular Kirkwood Commons center just across from Target on Lawndale Drive. The unit has two private offices, a large open space, bathroom and utility/storage closet. This is a condominium unit and was built in 1999.







POPULATION

1 Mile	3 Miles	5 Miles
7,535	85,919	212,805



AVERAGE HH INCOME

1 Mile	3 Miles	5 Miles
\$70,040	\$67,892	\$67,044



TRAFFIC

Lawndale Drive & Colonial Avenue
25,526 Vehicles Per Day

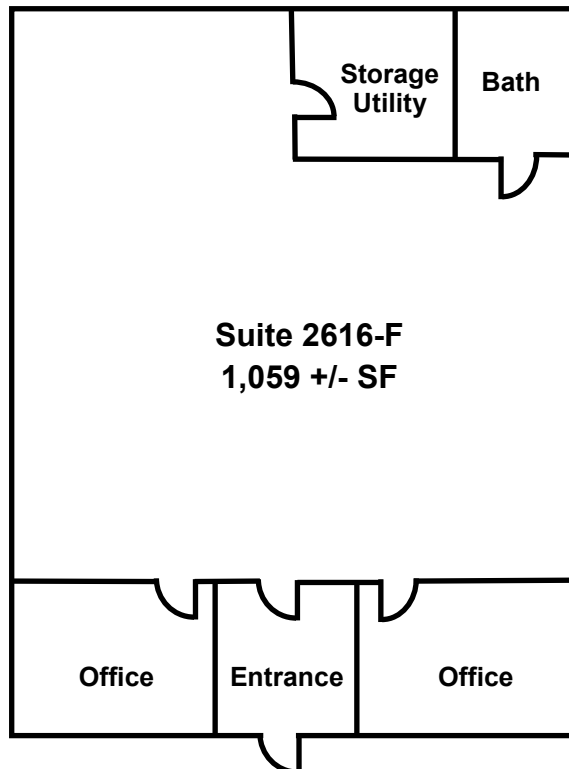

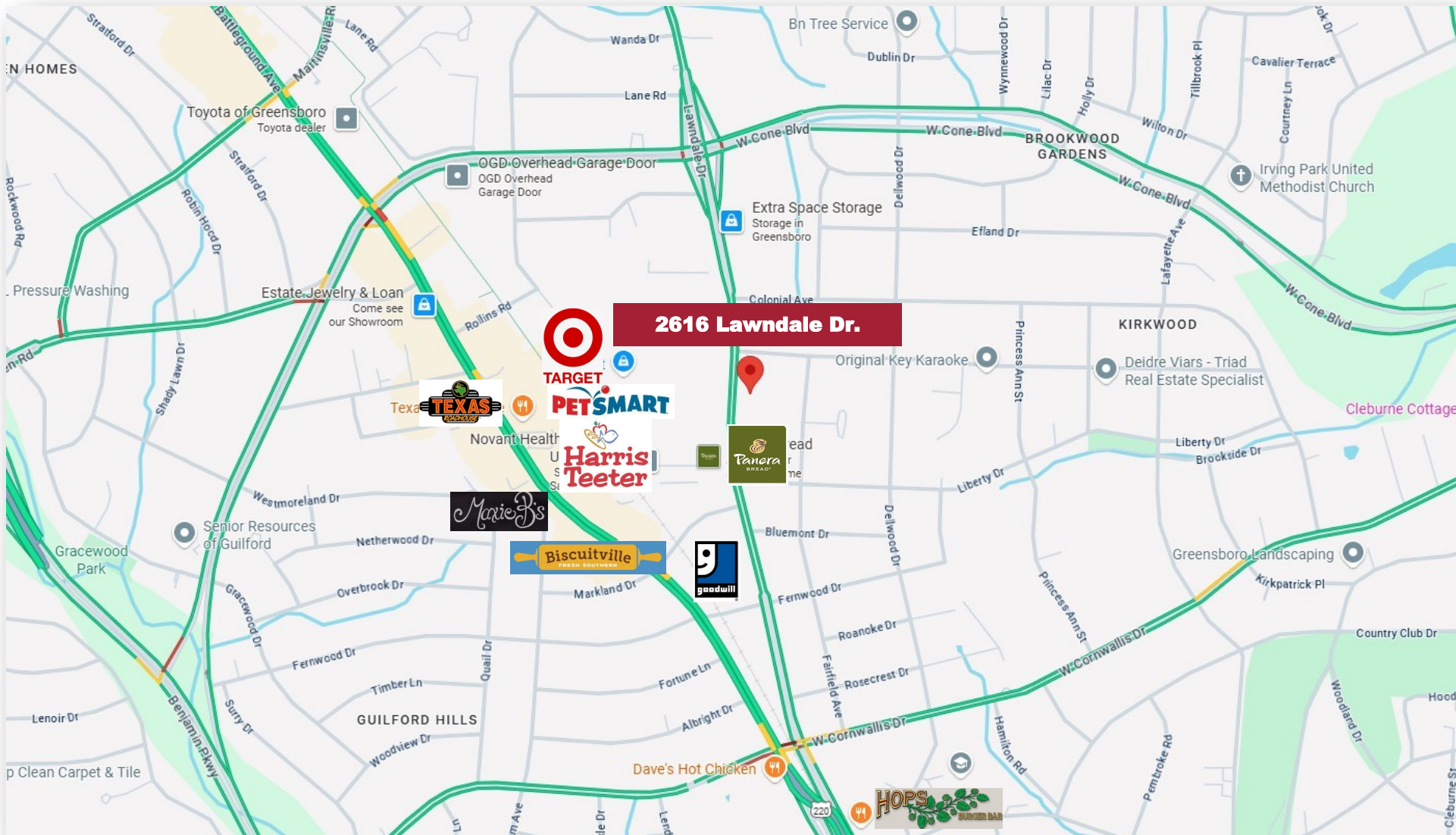

1007 Battleground Avenue, Suite 401, Greensboro NC 27408

The statements and figures herein while not guaranteed are secured from sources believed to be authoritative. This offering is subject to change of price, prior lease or sale and or withdrawal without notice. Prospects should verify all information.